



EXTERIOR Beneath the Penrhyn Welsh slate roof are 1890s polychromatic bricks with tuck-pointing. The cast-iron decorative lace balustrades and wrought-iron spear fence are original.

LIVING An Original BTC 'Fin' pendant from Dunlin Lighting hangs over a rug from Designer Rugs. Fable stool, Trit House. Viggo Boesen 'Little Petra' armchairs, Cult Design.



HISTORY PROJECT

The renovation of a heritage home in one of Sydney's oldest areas required imaginative use of salvaged materials and a deep dive into local history.

STORY *Laura Barry* | STYLING *Sophie Wilson*
PHOTOGRAPHY *Brigid Arnott*

KITCHEN The new cabinetry was installed by Seaside Joinery. Rosso Alpi marble benchtops, Granite & Marble Works. Stone pavers, Eco Outdoor. Wall sconce, Cranmore Home. Ollo Seven pendant, Soktas. Bar stools, Great Dane. Tapware, Brodware. Artwork is heritage photography.
PORTRAIT *Opposite* Architect Angelique Perak.



Located in the heritage precinct of Millers Point, this 1890s Sydney home is a beautiful example of early Federation Queen Anne-style terrace architecture – and that makes it something of a precious gem, says Angelique Perak, lead architect and interior designer at Studio Duo, who was engaged by the homeowners to update the property.

“Long-standing clients of ours asked us to accompany them while they were looking for a heritage terrace to purchase and restore,” she says. “So we immersed ourselves in the context of the area and the story of those who built here. Then we drew on the intricate proportions of the existing built forms to inspire the transformation that the homeowners required.”

Purchased in 2019 by a couple with four children (plus a beloved pooch), the renovation works began in March 2020 after heritage and council approvals were obtained. Work was completed in September 2021. “The owners’ brief was to make the home more functional for a modern family through the adaptation of its spaces, but all this work had to maintain a reverence to the heritage significance of the house,” says Angelique. “It required a delicate balance. The reuse of materials, and the process of maintaining them on site under heritage guidance, offered us opportunities to reimagine them in some more useful, more relevant forms.”

Internally, the colour scheme was inspired by sandstone, the water of the wharves and the coppery tones of the chimney pots, and was designed to provide a neutral backdrop against which the detailed joinery and furniture could shine. White is washed across every wall while a combination of paving and dark timber flooring provides depth and contrast. Natural materials are present throughout, and texture appears in the tiles, plush upholstery and shapely lighting.

“The owners are very trusting and allowed me to come up with preliminary selections for colour palettes and fabrics, then ►



they refined the final selections during showroom visits,” says Angelique. Australian lighting, artwork and furniture celebrate the unique history of the house, such as the Bridge table by Meryl Hare that’s inspired by the Sydney Harbour Bridge, and the commissioned paintings, detailed etchings and heritage maps of the area that hang on the walls.

“One of my favourite spots would have to be the kitchen,” says Angelique. “Managing the small proportions demanded a carefully planned design with no wasted space. The oven was custom-sized and a downdraft used rather than a rangehood, in order to preserve the original detailing of the space.”

It was the exterior restoration of the home that became the biggest challenge. “The old wash house was once part of an extended yard used for sanitation laneways during the plague. We needed to separate the stormwater and sewer, and this required an archaeologist to be on site,” she says. “By reconfiguring its doorways and spaces, this once-disused building has become a laundry and bathroom, with covered access from the house.”

The courtyard was redesigned to create an alfresco entertaining area, and the doorway between the dining area and kitchen on

the lower-ground floor was widened to bring in more natural light. Existing flagstone pavers were numbered, lifted, cleaned and relaid, and some of the old bricks were then reused to extend the garden edging.

The ground-floor balcony bathroom had hydronic heating installed, along with a large shower enclosure and basin, and a new bathroom was added on level one. In the attic, custom bunk beds for the children were installed, and the roof void was lined and carpeted to create an indoor cubby house.

“We worked hard to incorporate modern conveniences, such as indoor bathrooms, airconditioning and home automation, within the heritage fabric,” says Angelique. “All the work required careful coordination of consultants and trades. This terrace has now been transformed into a contemporary family home. The design unfolds to reveal a harmonious blend of old and new, celebrating the rich tapestry of Millers Point’s history.”

► *Studio Duo, East Gosford, NSW; 0409 777 968 or studioduo.com.au. Construct Central Coast, West Gosford, NSW; constructcentralcoast.com.au. Nature’s Vision Landscapes, Terrigal, NSW; naturesvision.com.au*



DINING A Hare + Klein ‘Bridge’ table, custom-made by The Wood Room, takes centre stage. Chairs, Gubi. Agnes pendant, The Montauk Lighting co. Artwork, *Light* by Jacob Spokes. **LIVING** *Opposite* Two Marcel Wanders ‘Mad’ chairs from Poliform are set by the fireplace. Nau side table and Gubi ‘FA33’ mirror, Cult Design. Sandstone flooring, Eco Outdoor.

HOUSES **H&G**

THIS IS THE LIFE

“To accommodate a family of six in a heritage house is not an easy task,” says the owner. “The home’s finished result has intensified our passion for the city and its history. Not only does the home have a great feel and energy, but there’s room for everyone even though the space is compact. There is a sense of unity, but also fun. The children really love the play and reading areas in the attic.”

THE LAYOUT

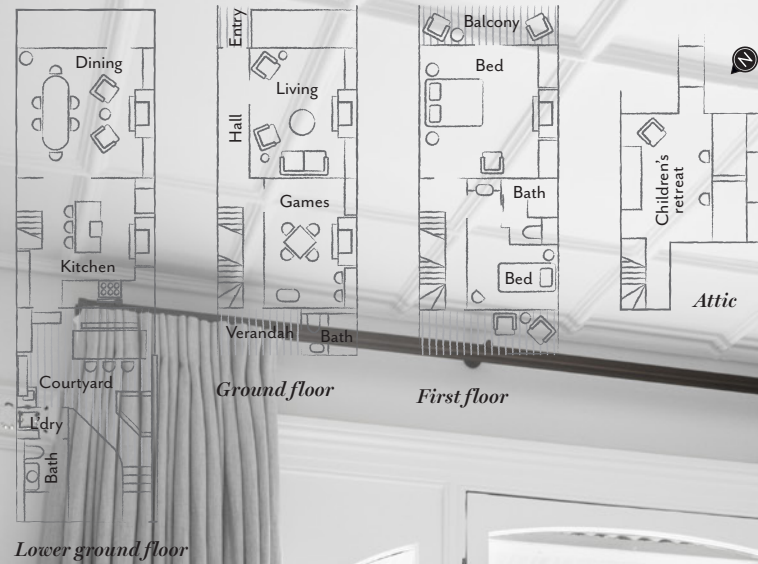

CHILDREN'S RETREAT *Top left* This room has carpet from Bremworth and a restored lath-and-plaster ceiling with timber battens. Custom bunk beds made by builder Ian Westlake. **WINDOW SEAT** *Top right* The window seat features custom cushioning by Heritage Upholstery. **BEDROOM** *Above left* The wall panels and bed were made by Seaside Joinery. Paolo Piva 'Onda' side table, Poliform. **BATHROOM** *Above right* Inax 'Yuki' tiles from Artedomus give the bathroom its texture. Camelhaas sandstone pavers, Eco Outdoor. Mirrored cabinet and vanity with Essastone benchtop, Seaside Joinery. Agape 'Vieques' basin, Artedomus. Frameless shower screen, Exclusive Glass Products. **BEDROOM** *Opposite* Angelique designed the wardrobe for this space. Hare + Klein 'Wings' rug, Designer Rugs. Curtains, Simple Studio. ►

THE PALETTE

Resene Quarter Ecru White
(interior walls)

Resene Half Ash (cabinetry)

Resene Artemis (island bench)

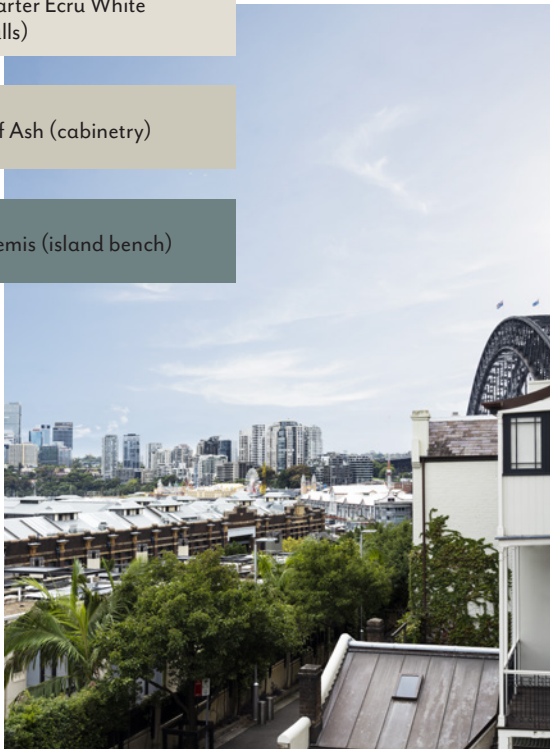

OUTLOOK *Top left* This home enjoys glimpses of the Sydney Harbour Bridge. **GAMES ROOM** *Top right and bottom left and right* A painting by Jane Bennett hangs over Miniforms 'Vitos' stools from James Richardson Furniture, plus there's a selection of photos, letters, maps and paintings curated by Angelique. Hay chairs from Cult Design and a custom games table stand beside a Café Lighting & Living bar cart and Nuura 'Blossi' floor lamp from Great Dane. Artwork by the games table is a framed heritage map. **COURTYARD** *Opposite* The alfresco area is furnished with a table and bench from Cotswold InOut Furniture and Knot dining chairs from Janus et Cie. Pendant, LightCo.

Paint colours are reproduced as accurately as printing processes allow.





1

THE SOURCE

When a modern pavilion is paired with a heritage home, call on elegant pieces to expertly blend old and new.

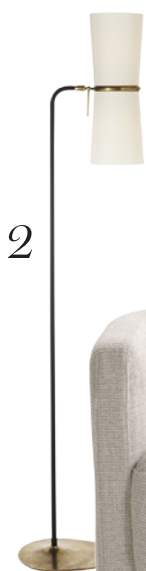

2

4



5



6



3



7



10



8



9



11

1 Bodega outdoor **wall light**, \$455, Coco Republic. 2 B345L **floor lamp**, \$2230, Contents International Design. 3 Oliver Tub **armchair**, from \$940, King. 4 Designer Boys Art 'Sir Joseph Banks Collection' **Endeavour Specimen II print**, \$415, Living by Design. 5 Ferm Living 'Avant' **candelabra**, \$169, Asser + Co. 6 Moma **planter set**, \$110, Jones & Co. 7 Bedouin linen **cushion** (40x60cm) in Black, \$99.99, Living by Design. 8 Breakaway **blockout curtain** in Stone, POA, Wynstan. 9 Taro **dining table**, from \$11,650, Cult Design. 10 Gubi 'Beetle' **chair**, from \$670, Cult Design. 11 Belling 'Richmond Deluxe' **dual-fuel cooker**, \$11,499, Harvey Norman. *For Where to Buy, see page 190.* **H&G**

Produced by Saffron Sylvester.